

Welcome to the World of Precision Low Level E-Collar Training

E-Collar Technologies, Inc.

Copyright 2015 All Rights Reserved

Pro Educator Owner's Manual

Pro Educator Owner's Manual

Thank you for trusting us with your e-collar purchase, we appreciate it and will do everything possible to exceed your expectations. We have taken great care to provide ample safety features to assure a pleasant experience for you and your dog. It is important to condition your dog to low level stimulation by pairing it with soft leash pressure; you will always get better results with low level stimulation combined with consistent training techniques and a patient heart. The use of high levels of stimulation should only be used as a last resort and in life-threatening situations. We recommend all first time e-collar users obtain professional help or immerse themselves in the many online resources. Feel free to contact our customer service to obtain information on a professional trainer well versed in low level e-collar training in your area. Your complete satisfaction and successful training is our only concern.

* Additional information and help is available on www.ecollar.com and by e-mailing customerservice@ecollar.com. To talk to a live team member, please contact our customer service department, 8 AM to 8 PM E.S.T., 1-855-326-5527 or (260) 357-0051.

FEATURES

1/2 mile Range

Easily Expandable to 3 Dogs

Waterproof and Shock Resistant

User Adjustable Boosting Levels

Lock and Set Stimulation Feature

Collar Receiver Light for Night Tracking

Stimulation Levels Adjustable from 0 to 100

Employs Quick Charge Li-Polymer Batteries

Computer Connection for Additional Features

Patented "I" Mode Provides Instant Stimulation

Convenient Intensity Dial for Quick Adjustment

7 Selectable Vibrations and 4 Selectable Tones

2 Ramping Modes, 1 Second and 2 Second Ramp Boost

CONTENTS

- Ergonomic Transmitter - Remote-Sender

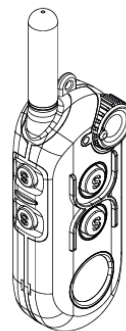

- Test Light

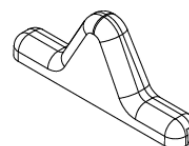

- Lanyard



- Waterproof Collar Receiver High Quality Biothane Strap

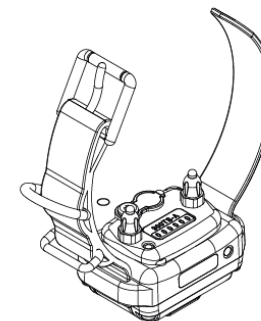

- Contact Point Tool



- Battery Charger

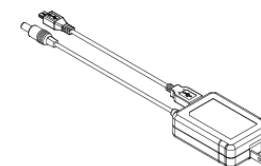

- Quick Start Owner's Guide



- 5/8" and 3/4" Contact Points

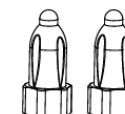

- Metal Belt Clip



TABLE OF CONTENTS

05	Safety and General Information
06	Transmitter Parts
07	Collar Receiver Parts
08	Charging the Batteries
Turning Your E-Collar On/Off --- 10	
The LCD Display Features --- 11	
Button Functions --- 12	
Program Stimulation Buttons and Factory Default Setting---14	
Maximum Durations for Stimulation, Vibration, Tone---15	
I Mode and Lock/Unlock Stimulation Lever---16	
Advanced Features---17	
Paring/Synching Procedures---18	
CHANGING THE INTENSITY LEVEL OF STIMULATION---19	
INDICATOR LIGHT---20	
TESTING YOUR E-COLLAR---21	
RECEPTION---22	
REPLACING THE CONTACT POINTS---24	
CORRECTLY FITTING THE COLLAR---25	
WARRANTY AND REGISTRATION---26	
ACCESSORIES---27	

SAFETY AND GENERAL INFORMATION

- The Pro Educator Education Collar complies with all National and International Standards and Guidelines for human exposure to radio frequency electromagnetic energy.
- Nearly all electronic devices are susceptible to electromagnetic interference (EMI) if inadequately shielded or designed without precautions to EMI.
- Pro Educator transmitters manufactured by E-Collar Technologies, Inc. comply with Article 15 of the FCC rules and operate under Part 95 of FCC regulations.
- Frequency of operation is 27.095 MHz.

IMPORTANT NOTICE

- To avoid Electromagnetic Interference and/or compatibility conflicts, please turn off your transmitter and collar receiver in any facility where posted notices instruct you to do so. Never use your equipment in close proximity of a Hospital or Health Care Facility or enter the facility without turning off both units.
- An FCC license is not needed to operate Pro Educator transmitters. However, any change or modification made to the transmitter, including the supplied antenna, without the expressed written approval of E-Collar Technologies, Inc. could void your authority to operate pursuant to FCC Rules and Regulations.

TRANSMITTER FEATURES

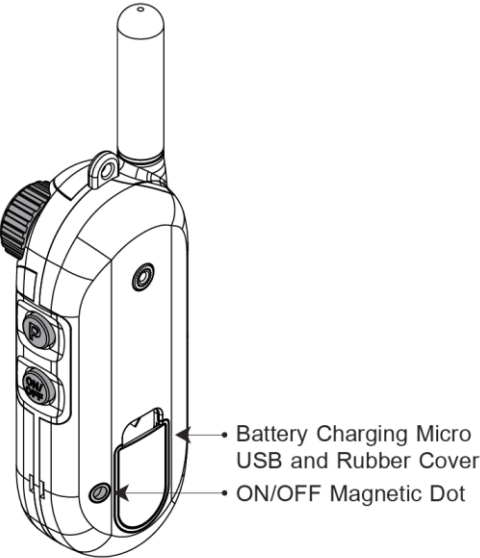
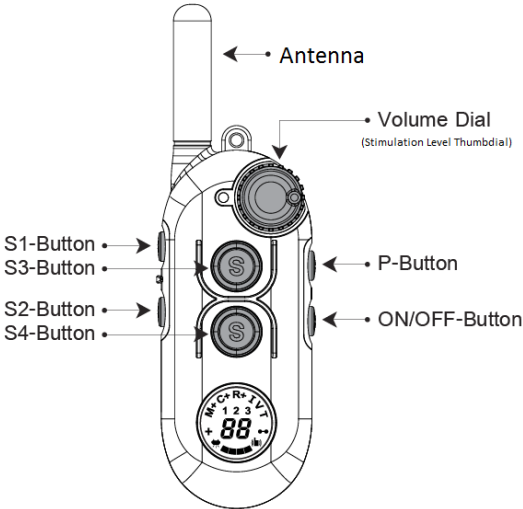

COLLAR RECEIVER PARTS

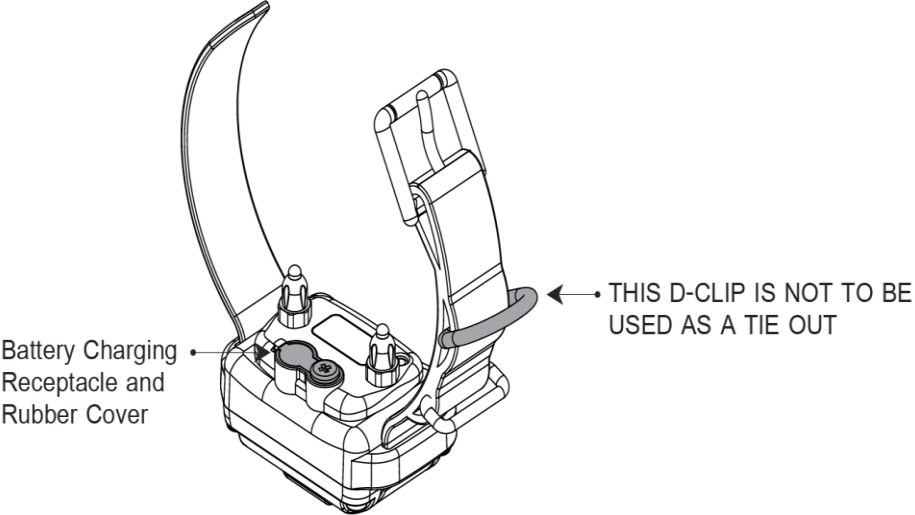
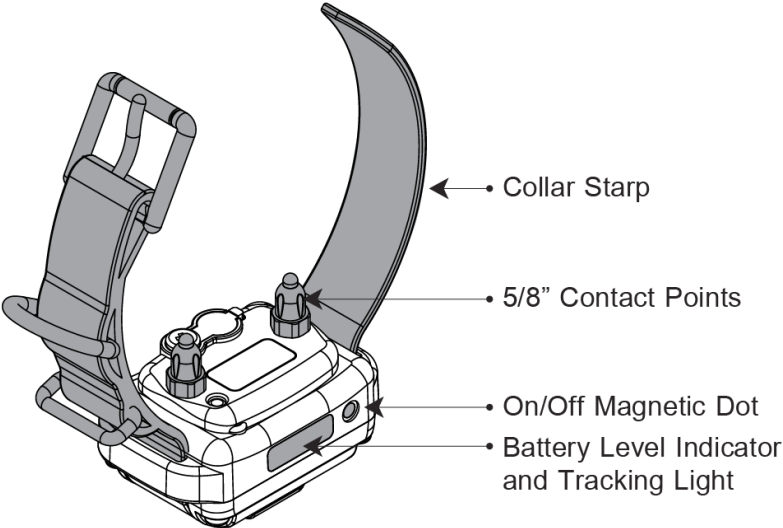

CHARGING THE BATTERIES

The collar receiver and transmitter Indicator lights will blink "Green" under normal operation and will change to "Red" when activated.

The batteries can be recharged whether the battery is fully drained or not, leaving them on the chargers in a cool dry place is okay. To charge insert the micro USB into transmitter and charging plug into receiver.

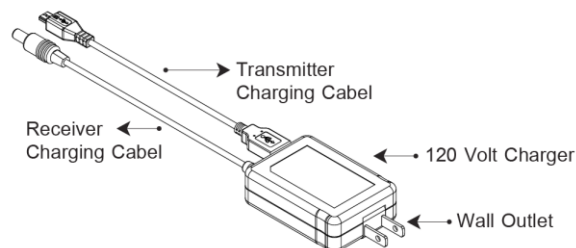

Low Battery Indication

Transmitter: The level of Battery life is displayed on the LCD below circled in red, charge prior to last bar for best battery longevity.



Receiver: Indicator Light will blink "Red" when recharging is required, for best battery longevity charge prior to red light, after approximately 30 hours of use.

We recommend you recalibrate your battery every six months by letting them fully discharge then fully charge them. Avoid allowing the batteries to fully discharge except when calibrating. Under normal use, it does not damage the batteries to charge them before they are fully discharged. Keep batteries away from high heat at all times, leaving them in the sun or hot location will damage them and require replacement. Replacement batteries can be found on www.ecollar.com at reasonable prices with free shipping, we purposely made them easy to change.

Long Term Storage: Do not store fully charged or discharged, store at approximately 60% of charge and in a cool place, heat will lower the lifespan of Li Polymer type batteries.

WHERE TO CONNECT THE CHARGER

Transmitter Battery Charging receptacle is a micro USB found under the rubber cover as seen below:

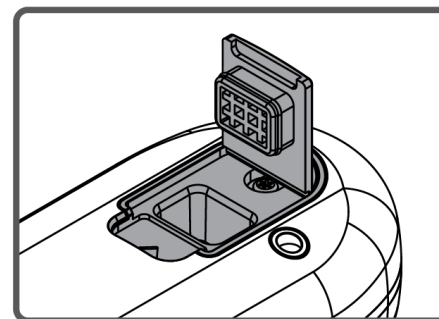

Collar Receiver Battery Charging Receptacle can be found under the rubber dust cover as seen below:

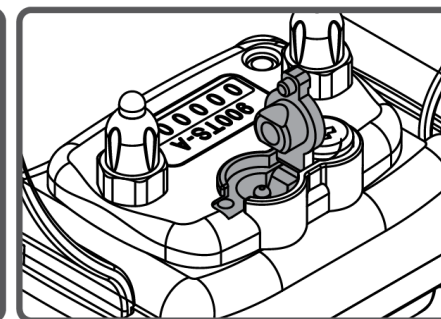

The indicator light will turn solid red during charge cycle and turn green when it is fully charged.

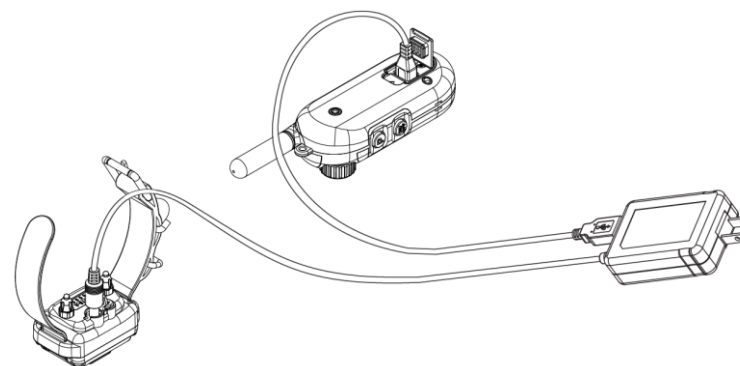

Special Note: The indicator light may not turn green after the first few charges due to the nature of the Li-Polymer batteries.

TURNING YOUR E-COLLAR ON and OFF

COLLAR RECEIVER is turned ON/OFF using magnet technology

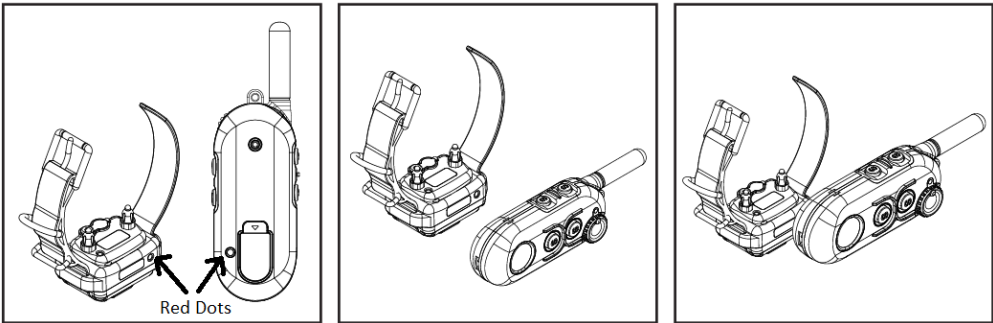

Position the red dot on the Transmitter close to the small red dot hole on the receiver. After turning on the unit, push the vibration or tone button to assure the collar receiver is turned on and functioning properly before putting it on your dog.

THE ON/OFF BUTTON IS LOCATED ON THE LOWER RIGHT SIDE OF THE TRANSMITTER:

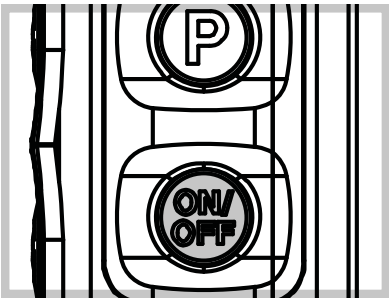

Turning the Transmitter ON and OFF

To turn ON, press the "ON/OFF Button" for more than 1 second.

To turn OFF, press the "ON/OFF Button" for more than 2 seconds.

THE LCD DISPLAY NOMENCLATURE



Icon	Description	Action
M	Momentary Stimulation	Sends Single Pulse of Stimulation
M+	Momentary Boost Stimulation	Sends Single Pulse of Boosted Stimulation
C	Continuous Stimulation	Sends Continuous Pulses of Stimulation
C+	Continuous Boost Stimulation	Sends Continuous Pulses of Boosted Stimulation
R	1 Second Ramp Stimulation	Ramps Stimulation from 0 to Level Set by the Stimulation Dial
R+	2 Second Ramp Boosted Stimulation	Ramps Stimulation from 0 to Boosted Stimulation Level
I	Instant Mode	Dial Controls Stimulation for up to 45 Seconds
V	Vibration	Vibration Sensation Similar to Cell Phone Vibration Mode
T	Tone	Tone can be a Warning or a Good Dog Marker
+	Boost Level Setting	Sets Boost Level for Each Dog
🦋	Light	Turn ON/OFF Night Tracking Light
📶	Lost Transmitter	6 Hours Timer Setting for Beeper
🔗	Pairing/Syncing of Collar Receivers	Allows for "In the Field" Pairing of Collar Receivers
1 2 3	Selection of Multi Dog Operation	Multi Dog Mode Indicator
88	Stimulation Level Indication	0 to 100 Levels of Stimulation
🔋	Battery Indicator	Indicates Transmitter Battery Level

TRANSMITTER BUTTON DESCRIPTIONS AND FUNCTIONS

The Pro Educator has 4 control buttons that can be programmed to any one of the seven stimulation modes, vibration and/or tone. They are labeled S1, S2, S3 and S4. The program control button is conveniently located on the top right side of the transmitter labeled "P".

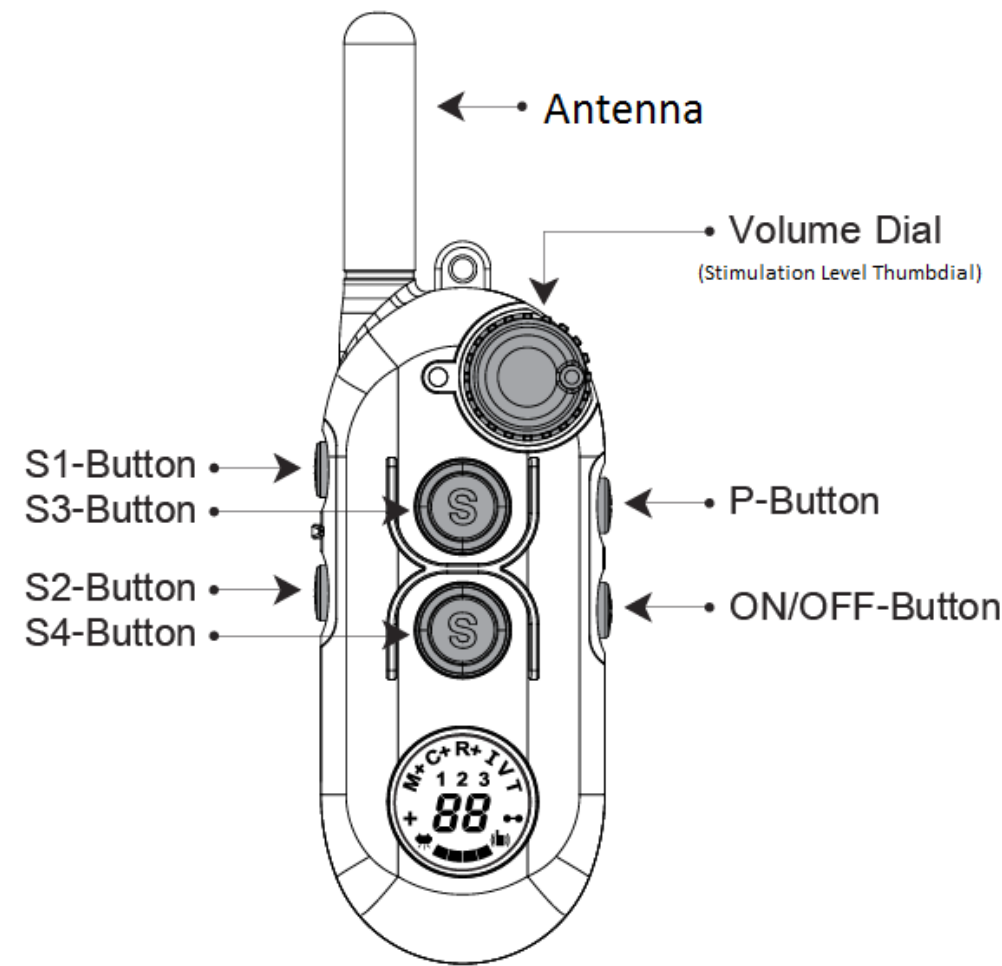

BUTTON FUNCTIONS AND ACTIONS

Buttons Functions	Function	Action
ON/OFF (Bottom Right)	Power ON/OFF	Press 1 Second to Turn ON Press 2 Seconds to Turn OFF
P (Top Left)	(1) Programs the 4 Control Buttons S1, S2, S3, and S4 (2) It also allows entry into the Boost Level, Tracking Light, Lost Transmitter Beeper and Receiver Pairing	Press "P" for 1 Second to enter Programming Mode (Display will Flash). Press again to Exit the Programming Mode. Or wait for the 30 Second Time Out Feature
Pressing the ON/OFF Button While in Programming Mode Toggles Through the Boost Level, Tracking Light, Lost Transmitter Beeper, and Receiver Pairing Modes	(1) Selects Boost Level for Each Dog (2) Turns ON/OFF Night Tracking Light (3) Turns ON/OFF Lost Transmitter Beeper (4) Pairing/Syncing of Collar Receivers	Toggles the Transmitter through the additional modes available on the Pro Educator
Pressing the ON/OFF Button and S1 Button together.	Toggles Between the Dog 1, Dog 2 and Dog 3 modes	The LCD display will show 1, 2, or 3 and will provide a confirmation beep.

Special Note: If you feel overwhelmed at this point, do not worry it will all come together once you get to playing with the transmitter.

BUTTON ASSIGNMENT FOR THE DIFFERENT DOG MODES

The 4 Control Buttons S1 through S4 will be assigned to the selected dog pursuant to following Table:

Control Buttons	Stimulation Button Assignment Table		
	1 Dog Mode	2 Dog Mode	3 Dog Mode
S1-Button	Dog 1	Dog 1	Dog 1
S2-Button	Dog 1	Dog 2	Dog 3
S3-Button	Dog 1	Dog 1	Dog 1
S4-Button	Dog 1	Dog 2	Dog 2

Before you go further select the dog mode; 1 Dog or 2 Dog or 3 Dog modes

PROGRAMMING CONTROL BUTTONS AND FACTORY DEFAULT SETTINGS

You can assign any 1 of the 9 functions to the S1, S2, S3 and S4 control buttons.

How to Program Control Buttons:

1. Press "P" button for more than 1 second until the LCD is flashing and is displayed.

2. Press the "S1" button repeatedly until you arrive at the function you desire for the "S1" button.

3. The default setting is "V" for the "S1", the sequence is as follows:

(V ▶ T ▶ M ▶ M+ ▶ C ▶ C+ ▶ R ▶ R+ ▶ I)

* Note : The "Lock and Set" feature is accomplished by selecting "M" or "C" mode and holding the "S1" button for one second before releasing it. Releasing

it too soon will toggle to the next mode. The Dog 1 icon will change to solid when level is locked. Flashing Dog 1 icon indicates stimulation level will determined by the volume/stimulation dial.

4. Repeat the same sequence for the S2, S3 and S4 buttons.

**** IMPORTANT NOTICE ****

Sometimes in the multi-dog mode the user needs to recall the settings and/or stimulation level setting of a particular dog because the display always shows the last dog stimulated. Simply enter the programming mode and push the particular control button you want to recall the setting for, the first push will not change that setting.

5. Press "P" at any time in the programming to return to active use of the training collar.

Factory Default Setting

Control Buttons	Factory Default Setting					
	1 Dog Mode		2 Dog Mode		3 Dog Mode	
S1	1D	Momentary	1D	Momentary	1D	Momentary
S2	1D	Continuous	2D	Momentary	3D	Momentary
S3	1D	Vibration	1D	Vibration	1D	Vibration
S4	1D	Tone	2D	Vibration	2D	Momentary

Turn on the collar receiver(s) and test each one to make sure everything is working, use the test light to test the stimulation or the palm of your hand at levels no greater than 20, users with dry hands should test it on their forearms.

Maximum Durations for Stimulation, Vibration, Tone

- (1) Continuous Stimulation "C" Mode: 10 Seconds.
- (2) Continuous Boosted Stimulation "C+" Mode: 10 Seconds.
- (3) Ramp "R" and Ramp Plus "R+" Modes: 10 Seconds
- (4) Instant Stimulation "I" Mode: 45 Seconds
- (5) Vibration and Tone Modes: 30 Seconds

I Mode and Lock/Unlock Stimulation Level

* How Instant Stimulation "I" Mode Works

1. Assign instant stimulation "I" mode function to one of the control buttons.

IMPORTANT NOTICE: The stimulation dial must be turned to "0" to start the "I" mode.

2. To start the "I" mode, push the assigned control button. The display will flash  and is ready to begin stimulation.
3. Turning the stimulation will now activate the stimulation at the setting of the dial and continue for 45 seconds. Returning to "0" will reset the 45 second safety timer.
4. If you do not rotate the dial for 45 seconds the "I" mode will turn off and the control button will need to be pushed again.
5. Pushing any of the other control buttons will turn off the "I" mode and

therefore require the "I" mode control button to be pushed again to reactivate it.

6. Again, to exit the Instant Mode, press any control button or wait for 45 seconds. A tone will beep when the "I" mode times out.

7. Should the dog not require stimulation during the 45 seconds and you want the "I" mode to stay on, periodical turn the dial up to reset the timer, very few dogs can feel levels 1 and 2. **"I" mode is not recommended for sensitive dogs.**

Lock and Unlock Stimulation Level

1. Press "P" button for more than 1 sec to enter into Programming Mode.
2. Confirm all the icons are blinking and  is displayed.
3. Assign "M" or "C" function to any of the four control buttons by pressing the particular control button until "M" or "C" are displayed. (Refer to Button Assignment Table)
4. Rotate the stimulation dial to the desired level; now push the particular control button for 1 second until the 1, 2, or 3 icon stops flashing. Solid icon indicates locked stimulation.
5. Press "P" button to save and exit from the Programming Mode.
6. To unlock the locked stimulation level, repeat above step and confirm by noticing the 1, 2, or 3 dog icon is flashing.

Special Note: In the multi-dog modes, any of the dogs can be locked or unlocked independent of the other dogs.

Flashing icons indicated unlocked and solid icons indicate locked.

ADVANCED FEATURES

You can enter into advanced feature mode by pressing the P Button (upper right) then the ON/OFF button (bottom right).

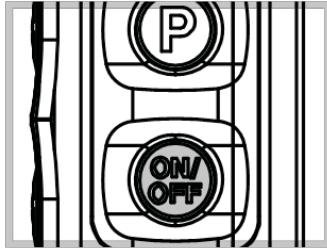

3. Rotate volume dial to setup boosting level from 1 to 60.
4. Press this stimulation button again to save the boosting level.

Confirm icon (M+ or C+) blinked one time.

5. Press P button to save and exit from Programming Mode.

Boosted Stimulation Level Setup

1. Press P button for 1 second to enter the Programming Mode.
2. Confirm all the icons are blinking and **PR** is displayed.
3. Enter into "Boost Level Setup Mode" by pressing ON/OFF button 1 time.
4. Confirm **+** is displayed on the LCD display.
5. Rotate volume dial to setup boosting level from 1 to 60.
6. Save boosting level by pressing the Stimulation Button (S1 for dog 1, S2 for dog 3 and S3 for Dog 3) to save the boost level you want for that particular dog.
7. Press P button again to exit from Button Programming Mode.

Or For a Quicker Means of Setting the Boost Levels

1. Assign M+ or C+ function to any of stimulation button needs to be change by pressing P button and stimulation button. (Refer to Button Assignment Table)
2. Confirm M+ or C+ is selected for this button.

* Turn ON/OFF Receiver Light(s)

1. Press P button for more than 1 sec to enter into Programming Mode.
2. Confirm all the icons are blinking and **PR** is displayed.
3. Press ON/OFF button twice to select  icon and "**Lc**" is displayed.
4. Press the control button assigned to the dog you want to turn ON/OFF the night tracking light.

Light Activation Cycle of Receiver is Blinking - Solid - Off

5. Press P button to exit from Programming Mode.

LOST TRANSMITTER MODE is useful when you are going on a training trip and you want to be able to locate your transmitter. Remember, to plan ahead so the location beeper turns on at the appropriate time. It will start beeping 6 hours after the activation, turn off and back on the transmitter to turn off the lost transmitter beeper.

Lost Transmitter Activation:

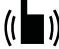
1. Press P button for more than 1 sec to enter into Programming Mode.
2. Confirm all the icons are blinking and **PR** is displayed.
3. Press ON/OFF button three times to select  icon at LCD display.
4. Press any of stimulation control button to turn it ON or OFF.
5. Press P button to exit from Programming Mode.

Paring/Syncing Procedure

The Pro Educator can control up to 3 different dogs at the same time.

Pairing/Syncing Procedure in the 1D Mode :

1. Confirm that Multi Dog Mode Indicator is 1 Dog Mode.
2. Press P button for more than 1 second to enter into Programming Mode.
3. Confirm all the icons are blinking and **PR** is displayed.
4. Press ON/OFF button four times to select  icon at LCD display.
5. Turn off the collar receiver. Hold the magnet for 5 seconds until the green light on the collar receiver flashes quickly.

6. Press any control button from S1 to S4 to perform pairing with a collar receiver.
7. Press P button to exit from Programming Mode

To add dog 2's collar receiver, change dog selection mode from 1D to 2D by pressing ON/OFF button+S1 button.

Pairing/Syncing Procedure in the 2D Mode:

1. Confirm that 1 and 2 dog icons are displayed on the LCD.
2. Press P button for more than 1 sec to enter into Programming Mode.
3. Confirm all the icons are blinking and **PR** is displayed.
4. Press ON/OFF button four times to select  icon at LCD display.
5. Turn off the 2nd collar receiver. Now hold the magnet for 5 seconds until the green light turns on and is flashing quickly..
6. Press S2 or S4 button to perform pairing with the dog 2 collar receiver.
7. Press P button to exit from Programming Mode.

To add dog 3's collar receiver, change dog selection mode from 2D to 3D by pressing ON/OFF button plus S1 button, three short beeps should be heard.

Pairing/Syncing Procedure in the 3D Mode:

1. Confirm that 1, 2 and 3 dog icons are displayed on the LCD display.
2. Press P button for more than 1 sec to enter into Programming Mode.
3. Confirm all the icons are blinking and **PR** is displayed.

4. Press ON/OFF button four times to select  icon at LCD display.
5. Turn off the 3rd collar receiver. Hold the magnet for 5 seconds until the green light on the collar receiver starts flashing quickly.
6. Press S2 button to pair/sync the dog 3 collar receiver.
7. Press P button to exit from Programming Mode.

Special Notice: It is possible and quite common to have 2 collar receivers on the same collar; this is known as a “plus” double collar system. The advantages of this type of outfit is; (1) Improved Sensation, it produces a fuller feel and is not just coming from one side of the neck (2) Contact reliability due to having contact points on both sides of the neck especially during exercise (3) Redundancy, should one collar receiver fail or loss battery life the user still has control (4) Increased Stimulation for those dogs that can be resistant and stubborn to obedience (5) Improved Range, having the collars at different orientations provide for better opportunity for the signal to reach the antenna on the collar receivers.



SELECTING THE CORRECT CONTACT POINTS

The standard 5/8” contact points are used for dogs with medium fur, longer fur dogs require the longer 3/4” contact points. Dogs with extremely thick fur will require special contact points to penetrate and provide reliable continuity. The contact points must touch the skin to use low level stimulation on the dog. We offer a variety of contact points to accommodate the varying furs, pictured below are a few of them:



The micro probes are great for Pit Bull Terriers, Boxers, Dachshunds and Dobermans while the thick haired contact points are needed for Huskies and Malamutes. Newfoundland's should use the 1 inch extra-long contact points. These are available for a nominal cost of \$8.00 per set with free shipping on www.ecollar.com in the accessories section.

Due to the increase in poorly manufactured imported stainless steel dog products, many modern dogs have developed sensitivity to nickel. If your dog exhibits any pinkish irritation after a few hours of the e-collar on them it is highly recommended to use nickel free hypoallergenic contact points, also available on www.ecollar.com. Both nickel free stainless steel and 100% titanium contact points are available at reasonable prices.

HOW TO CHANGE THE CONTACT POINTS

1. Loosen both contact points by rotating the contact point counter clockwise using the contact point tool or wrench.

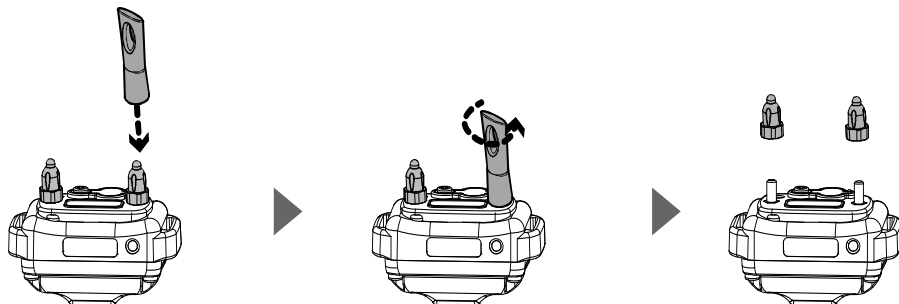

2. Install the desired contact points onto the bolt and tighten the contact points by rotating them clockwise with the contact point tool or wrench.

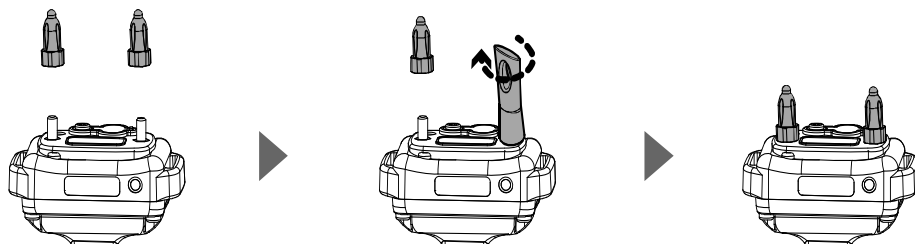

CORRECTLY FITTING THE COLLAR

The collar should be adjusted to allow the “contact points” to have direct contact with the skin. You should be able to fit a couple of fingers between the collar strap and your dog. Too tight poses the risk of skin irritation and discomfort. Too loose and the contact points will not be able to administer the stimulation reliably and can cause skin irritation due to chafing. A nice snug fit is best; always seat the collar receiver by giving it a little wiggle to remove any hair that

is between the contact points and the dog’s skin. The optimal position for the collar receiver is on either side of the dog’s windpipe in the 2 to 5 or the 7 to 10 o’clock position; most dogs don’t like it on their windpipes.

The dogs skin needs to be conditioned to the contact points this is accomplished by starting out with 1 to 2 hours and slowly working up to the absolute maximum of 12 hours per day. Periodically switching positions during a full day of e-collar use is good practice and can help prevent irritations from occurring. Inspecting the area is very important to assure your dog is handling the pressure from the contact points.

IMPORTANT NOTICE

To prevent the occurrence of skin irritations the collar receiver should never be worn for more than 12 hours per day. Should your dog experience skin irritations from over exposure to the contact points or allergic reaction to the nickel remove the collar receiver unit immediately and stop using your e-collar until the skin irritations are totally healed. Antibiotic ointment is suggested to aid in the healing process and prevent infections, a visit to your Veterinarian may be required should any open sores become infected.

CHANGING THE INTENSITY LEVEL OF STIMULATION

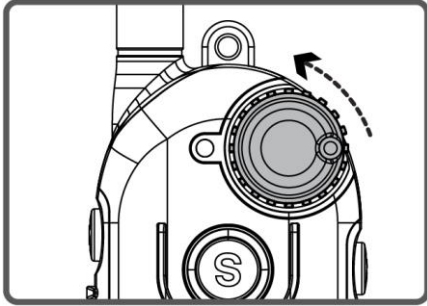

Rotating counter-clockwise increases the stimulation level and conversely, rotating clockwise lowers the stimulation level.

It is highly recommended that the user practices changing levels and modes before putting the collar receiver on the dog.

Setting the correct stimulation level for your dog is very important. To set your "conditioning" stimulation level, put the collar receiver (see page 25 for proper collar fitting technique) on your dog. Let him/her get used to the collar receiver for a couple of hours before applying any stimulation.

While watching your dog, turn the level to "1" and press the continuous stimulation button for 2 seconds, watch for the dog to make any indication of noticing the stimulation, this could be an eye twitch or scratching the collar receiver. Increase the level by one and repeat until you get a response, most dogs conditioning stimulation is between 5 and 20. You may need to increase the "conditioning level" a few levels to get your dog to respond, some dogs are more stubborn and need more stimulation. The "corrective" level is typically 5 to 30 levels higher than the "conditioning" level.

To condition the dog to the stimulation it is recommended you combine the

conditioning stimulation with light leash pressure by practicing come and heel commands with a short leash of long line. By combining the 2 sensations it will help the dog better understand the stimulation and prevent fearfulness should you need to turn the stimulation up at a later time. Timing and consistency is very important to successful e-collar training. When practicing the come and heel commands release the stimulation at the moment the dog turns toward you and is beginning to comply with the command. Once the dog is conditioned to the low level stimulation it is acceptable to begin using higher levels to work through any unwanted behaviors like jumping on visitors, counter surfing, trash investigation, not coming when called in high distractions. Using positive reinforcement for good behavior can speed the training process and provide a more pleasurable experience for you and your dog. It is your preference whether you use food or a verbal good dog as the positive reinforcement. Setting the "Corrective Stimulation" level is a little more difficult due to the wide differences in temperaments and stimulation tolerance among the many breeds of dogs. On average, it is normally 10 to 40 levels higher than the "Conditioning" level.

This e-collar is outfitted with the "I Mode" which is great for situations where an increasing type sensation is desired. For example, boundary training with the "I Mode" is accomplished by slowly increasing the stimulation as the dog exits the safe area, once he stops the stimulation remains on until he/she begins to retreat back to the safe area, slowly decrease the stimulation so it reaches zero at the precise instant the last paw is in the safe area, it is not important to rush this training as the dog will catch on soon enough, leaving the safe causes the sensation to increase while returning causes it to decrease. Once the dog gets it you can introduce distractions to proof the boundary training with higher dial speeds and higher levels of stimulation.

IMPORTANT TRAINING TIPS

E-Collars should be used to reinforce commands your dog already knows. It is not a replacement for basic leash obedience training, but a tool to allow you to better communicate to your dog. For best results, use the least amount of stimulation required to get compliance from your dog. A calm and consistent approach to training will always produce better long term results. It is highly recommended that aggressive dogs be taken to a professional trainer for evaluation before e-collar use. There are many different e-collar training techniques recommended by a variety of professional trainers. We believe you, the owner of the dog, can best determine the most successful technique for your dog. YouTube has many videos demonstrating these varying techniques by simply searching "educator e-collar training" or "remote dog training techniques with an educator".

Good luck with your training and feel free to contact us with any questions.

CAUTION: This product is not intended to be used on human beings except for testing the product at low levels.

WARNING: E-Collar Technologies, Inc. is not responsible for any misuse of this product and loss and damages as a result of a dog bite. Aggressive dogs should be evaluated by a professional trainer before e-collar use. It is not uncommon for aggressive dogs to associate the stimulation with the handler and take action against the handler. Sometimes dogs put under e-collar pressure during a fight can exhibit redirected aggression and become more aggressive.

INDICATOR LIGHT AND BATTERY LEVEL ICON

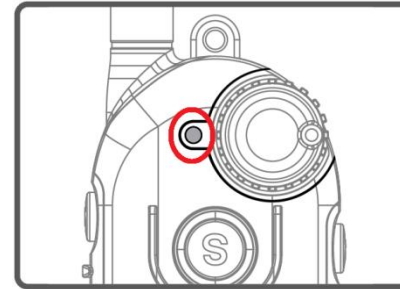

TRANSMITTER INDICATOR LIGHT

When any of the function buttons are pressed the indicator light will turn "red" to signify activation. The battery level is displayed as an icon on the LCD.

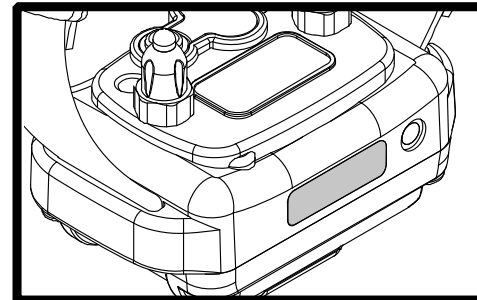

COLLAR RECEIVER INDICATOR LIGHT

Battery Charge level is signified by the flashing light going from "green" (ready for use) to "amber" (need to charge soon) and then to "red" (charge immediately). When

any of the function buttons of the transmitter are pressed, the indicator light on the collar receiver will flicker "red" indicating a control signal has been successfully received. It is best not to wait until it is red to charge Lithium Polymer batteries except when doing the periodic calibration.

TESTING YOUR E-COLLAR

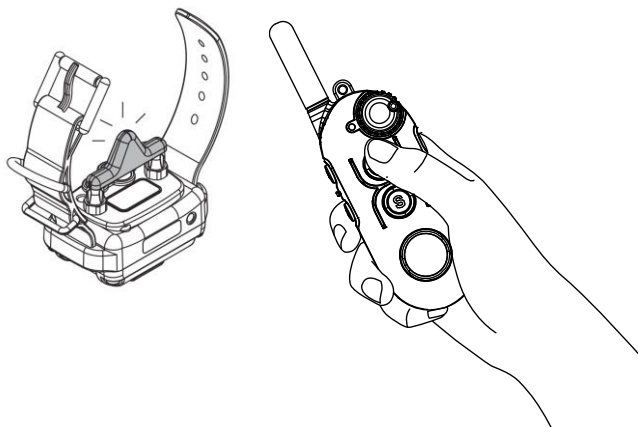

Hold the test light onto the contact points as shown in the above picture. With both units on and green lights flashing, press the continuous stimulation button while turning the stimulation up and down, the test light should brighten as you go higher in stimulation. The collar receiver light will change to red while the stimulation is on. Next, press the Vibration and Tone buttons to test them.

RADIO FREQUENCY RECEPTION BASICS

To obtain the maximum range hold the transmitter like the torch on the Statue of Liberty. Keep the antenna away from your body or fingers at all times, touching the antenna will greatly reduce the range.

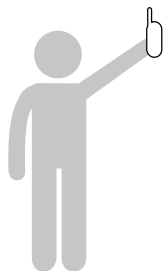

[Long Range]

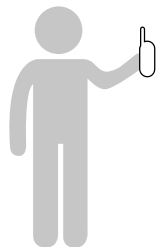

[Medium Range]

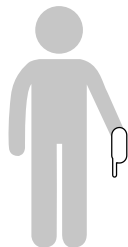

[Short Range]

WARRANTY AND REGISTRATION

To register your Pro Educator please select one of the following procedures:

(1) Go to the "Products" section on www.ecollar.com and click the "Register Your e-Collar Products" tab and complete the form.



(2) Fill out the provided warranty registration card and mail it or fax it to us at 1-855-326-5527.

(3) Call us at (260) 357-0051 and one of our customer service representatives will register your products for you, please have your serial number available.

SPECIAL NOTICE: We have been able to help many lost dogs find their owners by the serial numbers on the collar receivers.

TWO YEAR FULL WARRANTY

Your product is covered by our full two year warranty. During the warranty period we will repair and or replace your product for any reason due to workmanship and component failures. Dog chews and misuse are not covered by the warranty and are subject to a repair/replacement fee.

IMPORTANT NOTICE TO CONSUMER/USER

In no event shall E-Collar Technologies and its dealers/agents be liable for any direct, indirect, punitive, incidental, special consequential damages, to property or life, whatsoever arising out of or connected with the use or misuse of our products.

CHECK OUT THEVACCESSORIES AVAILABLE ON WWW.ECOLLAR.COM

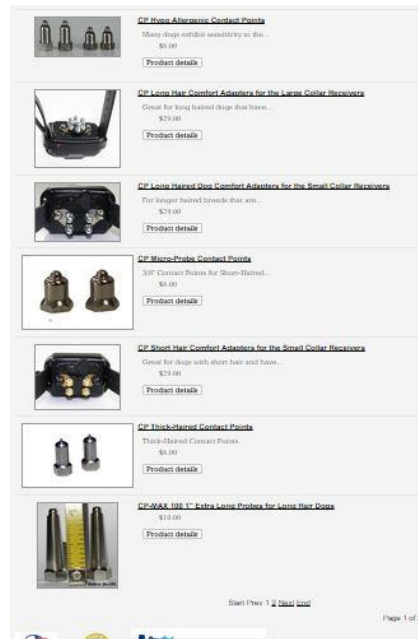

CONTACT INFORMATION

E-Collar Technologies, Inc.

2120 Forrest Park Drive

Garrett, IN 46738

Toll-Free 1-855-326-5527

Toll-Free Fax 1-855-226-5527

www.ecollar.com

sales@ecollar.com

customerservice@ecollar.com

This product is covered by various patents including but not limited to patents 8757098 and 8833309. Patent is pending on the Instant Feature on this device.

Copyright 2015 E-Collar Technologies, Inc. All Rights Reserved.



Thank you for Supporting American Workers